

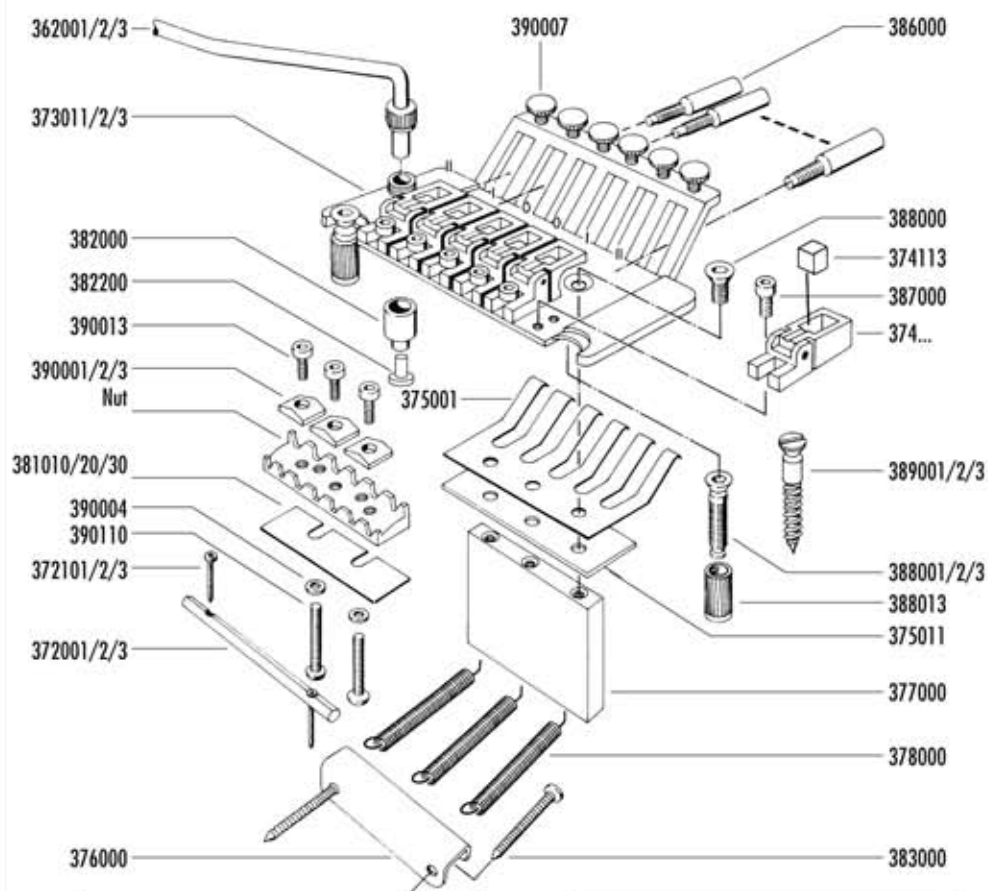

## "Floyd Rose" Tremolo



Part No.	Description	Color
362001cpl.	Tremolo arm	Chrome
362002cpl.	Tremolo arm	Gold
362003cpl.	Tremolo arm	Black
373011	Baseplate	Chrome
373012	Baseplate	Gold
373013	Baseplate	Black
390007	Finetuning screws	
386000	String lock screws	
387000	Saddle mounting screw	
374113	String lock insert	
389001	Pivot screw	Chrome
389002	Pivot screw	Gold
389003	Pivot screw	Black
388001	Pivot stud	Chrome
388002	Pivot stud	Gold
388003	Pivot stud	Black
388013	Insert	
375001	Bronze spring	
375011	Shim	
377000	Sustain block	
378000	Tremolo spring	
376000	Spring claw	
383000	Wood screw	
372001	String retainer	Chrome
372002	String retainer	Gold
372003	String retainer	Black
372101	Wood screw	Chrome
372102	Wood screw	Gold
372103	Wood screw	Black
390110	Neck screw	
390004	Washer	
381010	Shim 0.10 mm	
381020	Shim 0.20 mm	
381030	Shim 0.30 mm	
390001	Nut cap	Chrome
390002	Nut cap	Gold
390003	Nut cap	Black
390013	Nut screw	
382000	Hasp socket	Black
382200	Hasp socket screw	Black

NUT		
Part No.	Description	Color
381	Nut R1 - 39.69 mm	
382	Nut R2 - 41.28 mm	
383	Nut R3 - 42.86 mm	Chrome
384	Nut R4 - 42.86 mm	Chrome
385	Nut R5 - 44.45 mm	Chrome
386	Nut R6 - 39.69 mm	Chrome
387	Nut R7 - 41.28 mm	Chrome
391	Nut R1 - 39.69 mm	Gold
392	Nut R2 - 41.28 mm	Gold
393	Nut R3 - 42.86 mm	Gold
394	Nut R4 - 42.86 mm	Gold
395	Nut R5 - 44.45 mm	Gold
396	Nut R6 - 39.69 mm	Gold
397	Nut R7 - 41.28 mm	Gold
1381	Nut R1 - 39.69 mm	Black
1382	Nut R2 - 41.28 mm	Black
1383	Nut R3 - 42.86 mm	Black
1384	Nut R4 - 42.86 mm	Black
1385	Nut R5 - 44.45 mm	Black
1386	Nut R6 - 39.69 mm	Black
1387	Nut R7 - 41.28 mm	Black

SADDLES CPL. FOR ...STRING		
Part No.	Description	Color
374001	D+G	Chrome
374101	A+B	Chrome
374201	E+E	Chrome
374002	D+G	Gold
374102	A+B	Gold
374202	E+E	Gold
374003	D+G	Black
374103	A+B	Black
374203	E+E	Black

- Nut R1 = for Gibson flying "V", SG-Type
- Nut R2 = for Old Strat, Pacers
- Nut R3 = for Gibson Les Paul, narrow string distance
- Nut R4 = for B.C. Rich, Les Paul, widest string distance
- Nut R5 = for Boogie Body, Charvel
- Nut R6 = for Bullet, New Strat
- Nut R7 = for Bullet, Ibanez